

C & C

MILANO

CARNET



Baltico

"Man cannot discover new oceans unless he has the courage to lose sight of the shore."

- Andre Gide -

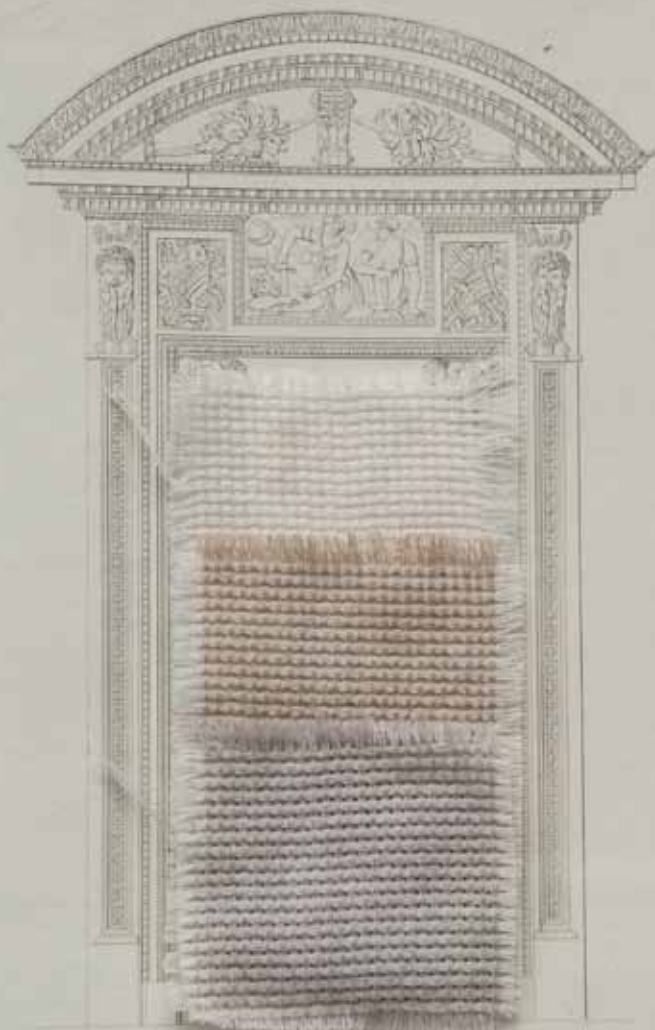

201446
Neve

201448
Sabbia

201450
Ghiaccio



in Piano di Ferro

del Ferro e Alluminio



Pandora

"Not all those who wander are lost."

- JRR Tolkien -



25

201428
Argento/Platino



Odino

201451
Ghiaccio

201452
Sabbia

201453
Neve

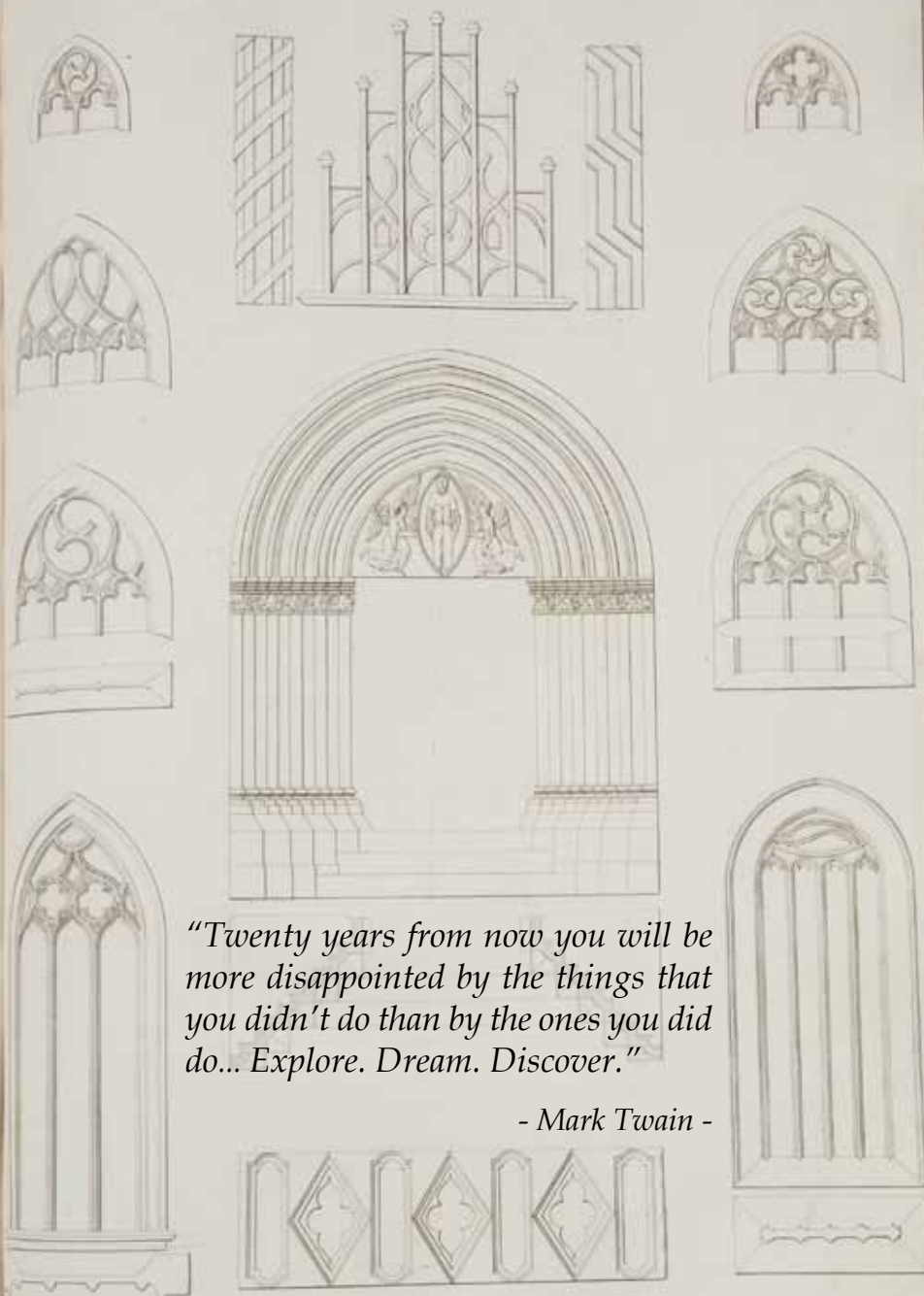

"Twenty years from now you will be more disappointed by the things that you didn't do than by the ones you did do... Explore. Dream. Discover."

- Mark Twain -



Tuareg

"In wisdom gathered over time I have found that every experience is a form of exploration."

- Ansel Adams -



*Temple de Sigeu de Denon
Partie du Temple de Denon*

Plan de Sigeu

Section du Temple



Plan de Sigeu
Section du Temple



201172
Tuareg Diamond
Sabbia/Cenere



201171
Tuareg Rigato
Sabbia/Cenere



201170
Tuareg Unito
Sabbia/Cenere



Plan de Sigeu
Section du Temple



*Temple de Sigeu de Denon
Partie du Temple de Denon*

Cirque élevé dans le Champ de Mars pour la fédération du 14 Juillet 1899 par Celerier



196690
Avorio



196693
Sabbia

Wafer

"I never travel without my diary. One should always have something sensational to read in the train."

- Oscar Wilde-

La Casa aperta nel Campo de Marte per la federazione del 14 Luglio 1790 dell'Opera

195579
Bianco ottico



196658
Cenere

Waffle

196912
Sabbia

196910
Bianco

196913
Iceberg

*"One's destination is never a place,
but a new way of seeing things."
- Henry Miller-*

110

Granolino



Musa



201178
Ghiaccio

Disponibile anche nelle varianti/
Available also in colorways
201176 Neve e 201177 Sabbia

"It is only in adventure that some people succeed in knowing themselves - in finding themselves."

- Andre Gide-

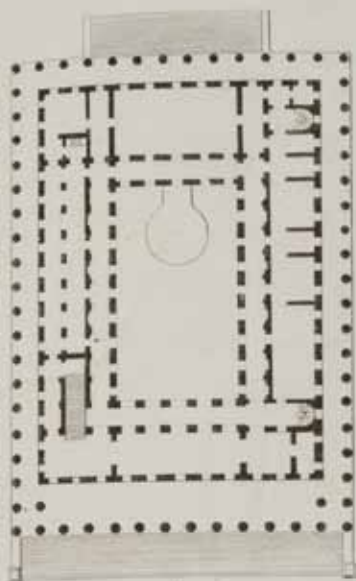

A



A

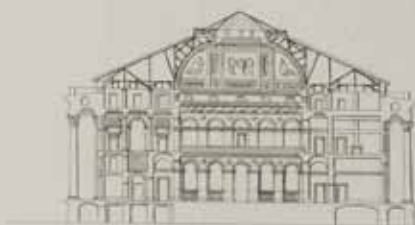

A

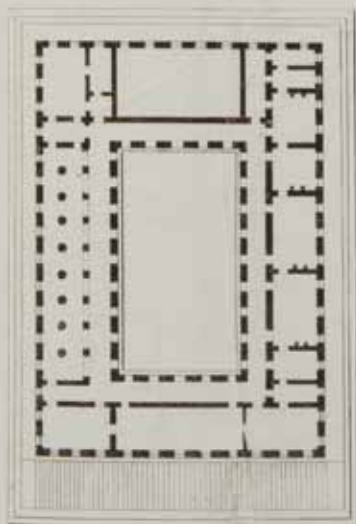

A

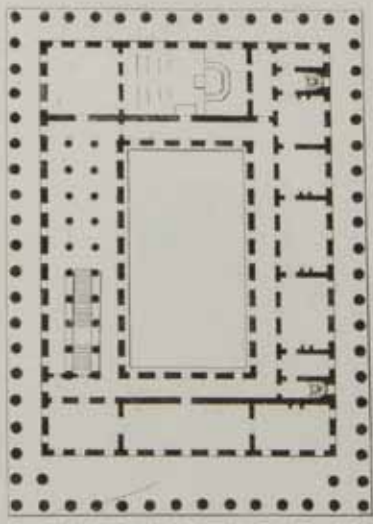

A

Aqueducs

L'Arnaud, bâti par Jacques de Brancas sous Louis de Rohan



de Cluses, bâti par Claude de Savoie 48 milles de longueur



de Metz, sur la Moselle



de la Compagne de Brancas, où les pierres ont presque cessé d'être



Pont de Card



"One's destination is never a place, but a new way of seeing things."

- Henry Miller -

201447
Sabbia

Aqueducts

Le Grand fabrique de l'usage de l'eau, represente Marie de Medis

Avalon

Le Grand l'ancien, fabrique de l'usage de l'eau, represente Marie de Medis

Le Petit, l'ancien

201449
Ghiaccio

201445
Neve



Enea

199824
Naturale

Omero

199823
Naturale





Anteo

199825
Naturale

199836
Naturale/Paglia

199835
Naturale/Menta

199834
Naturale/Anice

199838
Naturale/Ghiaia

*"Do not follow where the path may lead. Go
instead where there is no path and leave a trail."*

- Ralph Waldo Emerson-

HONG KONG
LONDON
MIAMI
MILANO
MÜNCHEN
NEW YORK

Via B. Zenale, 3 - 20123 Milano, Italy
T. +39 02 48015069
e-mail: office@cec-milano.com

CEC-MILANO.COM